

GENERAL FEATURES

- **GEL Technology** - The success of DG batteries comes from the internationally superior Gel technology. It is ideal for standby or frequent cyclic discharge applications under extreme environments
- **Front Access Connection** - Front access connection for fast, easy installation and maintenance with standard width for 19' and 23' ETSI racks.
- **Long Service Life** - Especially designed for telecommunication use with 10+ years design life in float service. By combining the newly developed paste formula with up-to-date GEL structures, this range features 12 years design life.
- **Maintenance-Free, Non-Spillable** - Proven VRLA technology guarantees safe operation without maintenance and 'non-restricted article' status for transportation.
- **Designed-In Reliability** - Cutting-edge manufacturing and process control combined with meticulous quality assurance procedures guarantee consistent and dependable performance

PERFORMANCE SPECIFICATIONS

Nominal Voltage	12V(6 cells)	
Design Floating Life @25°C	12 Years	
Nominal Capacity @25°C	20 hour rate 5.0A to 10.50V	100.0Ah
	10 hour rate 9.45A to 10.80V	94.5Ah
	5 hour rate 16.2A to 10.50V	81.0Ah
	3 hour rate 23.5A to 9.60V	70.5Ah
	1 hour rate 57.6A to 9.00V	57.6Ah
Internal Resistance	Full Charged Battery@25°C <4.8mΩ	
Energy Density (20-hr. rate)	93.03W-h/l	
Specific Energy (20-hr. rate)	36.36W-h/kg	
Shelf Life (nominal capacity at 20°C)	1 Month	97%
	3 Months	91%
	6 Months	83%
Max Short-Duration Discharge Current	5 Sec	1000.0A
Standby Use Charge (Constant Voltage) @25°C	Initial Charging Current Less than 30.0A Voltage 13.6 - 13.8V	
	Cycle Use Charge (Constant Voltage) @25°C Initial Charging Current Less than 30.0A Voltage 14.4 - 14.9V	
Operating Temperature Range	Charge	-20°C to 50°C
	Discharge	-40°C to 60°C

GENERAL FEATURES mm

Unit: mm

Length	410±1	Total Height	286±1
Width	110±1	Weight(kg)	33.0±1
Height	286±1		

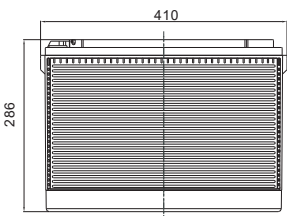

TERMINALS mm

F9 Terminal

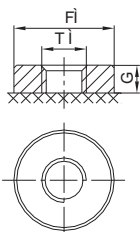

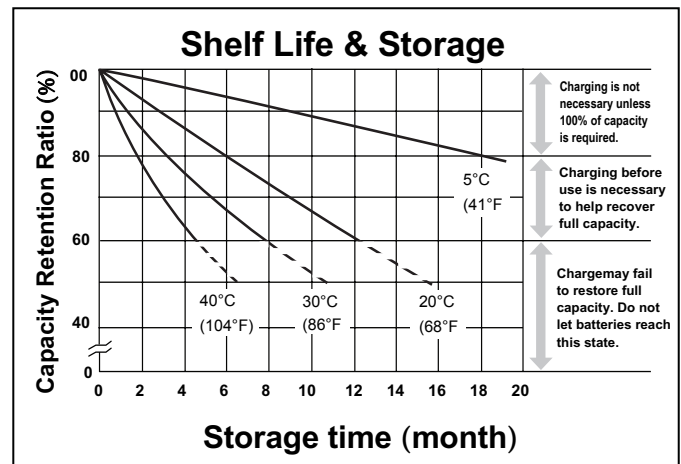
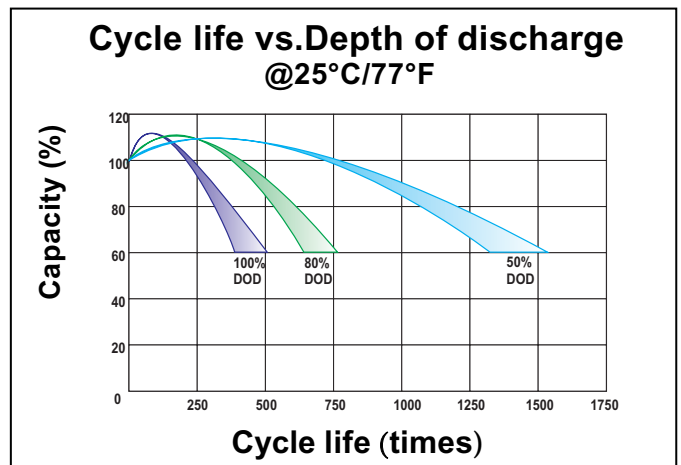
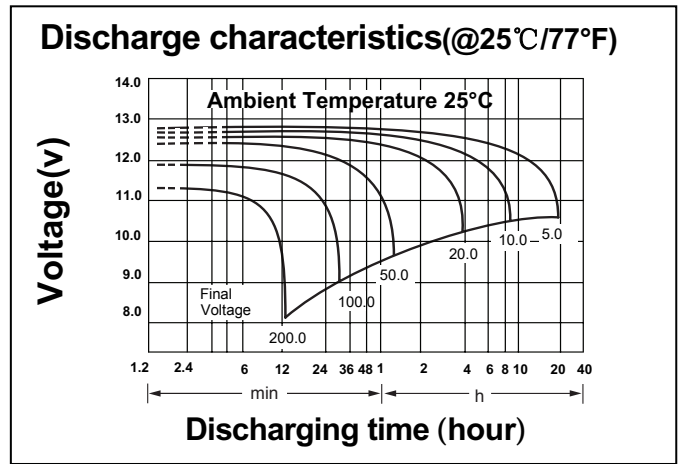

CONSTANT CURRENT DISCHARGE RATINGS (Amperes at 25°C)

F.V/Time	15MIN	30MIN	1HR	2HR	3HR	4HR	5HR	8HR	10HR	20HR
1.60V	1 69 . 7	99 . 2	5 7 . 6	3 4 . 5	2 4 . 8	2 0 . 2	1 7 . 0	1 1 . 6	1 0 . 1	5 . 1 7
1.65V	1 6 5 . 2	9 7 . 0	5 6 . 6	3 4 . 0	2 4 . 5	1 9 . 9	1 6 . 8	1 1 . 5	1 0 . 0	5 . 1 3
1.70V	1 5 9 . 4	9 4 . 1	5 5 . 2	3 3 . 4	2 4 . 1	1 9 . 6	1 6 . 6	1 1 . 3	9 . 8 5	5 . 0 7
1.75V	1 5 1 . 8	9 0 . 4	5 3 . 3	3 2 . 5	2 3 . 5	1 9 . 2	1 6 . 2	1 1 . 1	9 . 6 8	5 . 0 0
1.80V	1 4 2 . 0	8 5 . 5	5 0 . 9	3 1 . 3	2 2 . 7	1 8 . 6	1 5 . 8	1 0 . 9	9 . 4 5	4 . 9 0
1.85V	1 2 9 . 6	7 9 . 2	4 7 . 7	2 9 . 8	2 1 . 7	1 7 . 8	1 5 . 2	1 0 . 5	9 . 1 6	4 . 7 7